

Johannesgasse 15

1010 Wien

DG, Top 30

GR. HOF

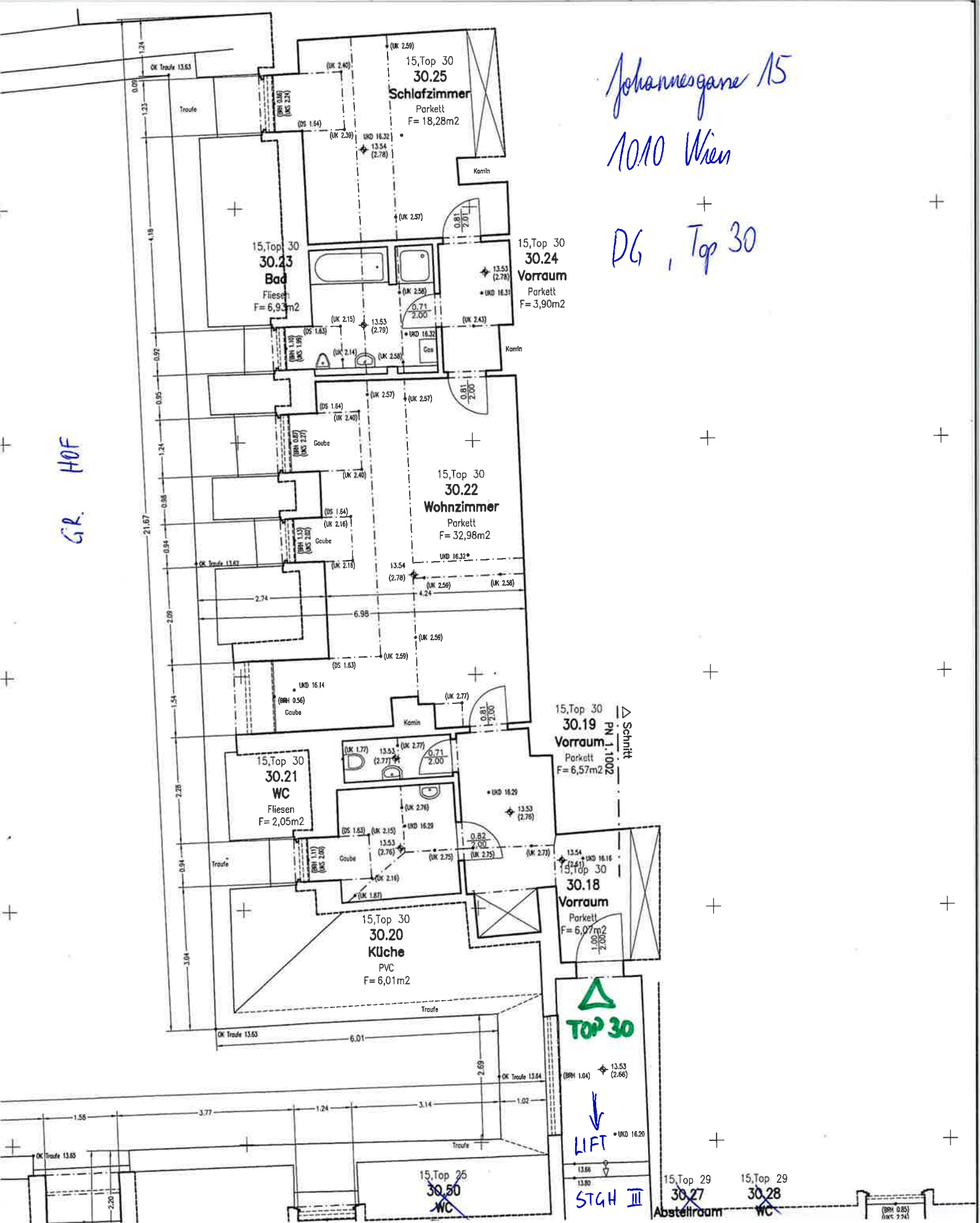

15, Top 30
30.19
Vorraum
Parkett
F=6,57m²

15, Top 30
30.18
Vorraum
Parkett
F=6,07m²

TOP 30

LIFT

STGH III

15, Top 29
30.27
Abstellraum

15, Top 29
30.28
WC